

# PACKO ICE BUILDER

## PIB 25 - 160



### Application

**Ice water** is used since many years for **cooling of food products and for process cooling in general** because ice water has the capacity to cool down large quantities of product in a short time. In an ice builder a **big amount of energy can be stored** on a small surface. This compact unit can produce a **large quantity of ice water of 0.5 à 1°C**. For several applications, **there is no risk of freezing the product**.

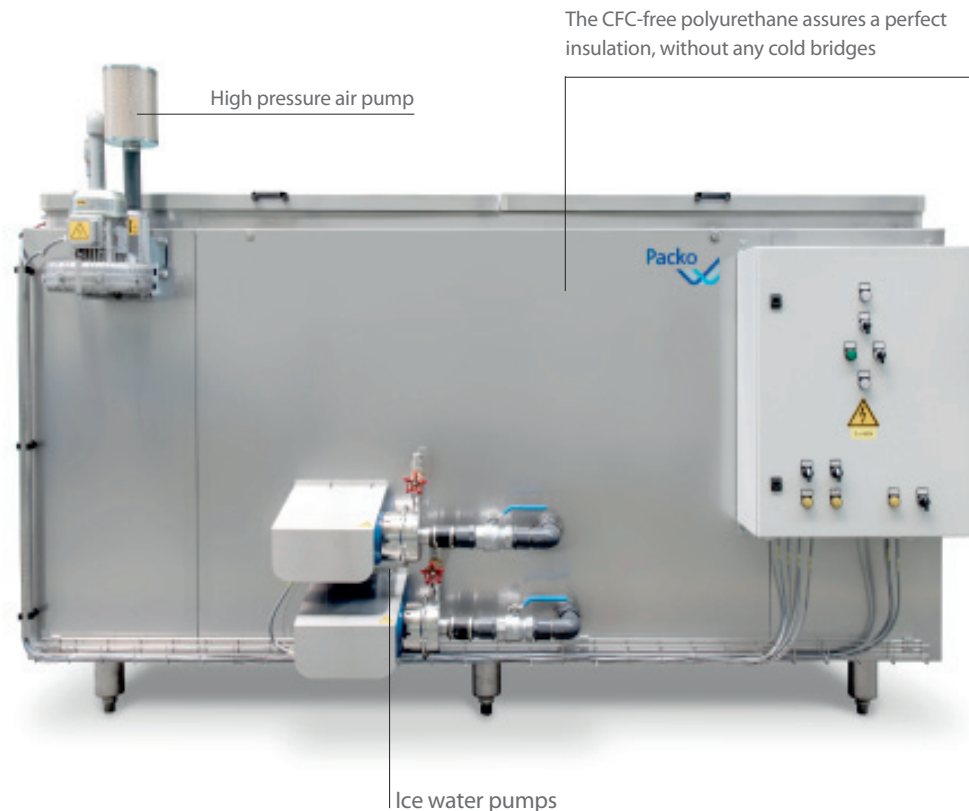

### Construction

- Construction completely made in stainless steel 18/10 – AISI 304
- Insulated with polyurethane foam for an excellent insulation and extra strength of the tank
- The well dimensioned evaporator enables the storage of a large ice reserve, this guarantees a maximum cold transfer
- The evaporator is made of seamless copper tubes and mounted in a stainless steel frame for a long lifetime

### Operation

- Accumulation of energy at cheaper electricity rates via e.g. night rate or alternative energy such as solar panels
- An ice thickness probe activates the Eco-cool cooling unit until an equal layer of ice on all evaporator tubes has been built
- When an exceptional rise in ice water demand is foreseen, the boost button allows the operator to start the cooling unit without reaching the minimum ice level.
- A time clock for ice building during the night or in a programmed period
- The water in the ice builder is cooled to 0.5°C.
- By means of one or more ice water pumps the ice water is sent to the consumer(s).
- The ice is melted down by the warm water returning from the consumer
- One high pressure air blower pushes compressed air through a PVC-collector on the bottom of the ice builder. This air causes sufficient turbulence in the water so the ice melts evenly, which guarantees a water temperature of 0.5 °C
- When the ice water is used in a not completely closed circuit, and some ice water be consumed or drained, an automatic level control unit maintains the ice water up to the required level.

# DIMENSIONS

## PIB 25 - 160

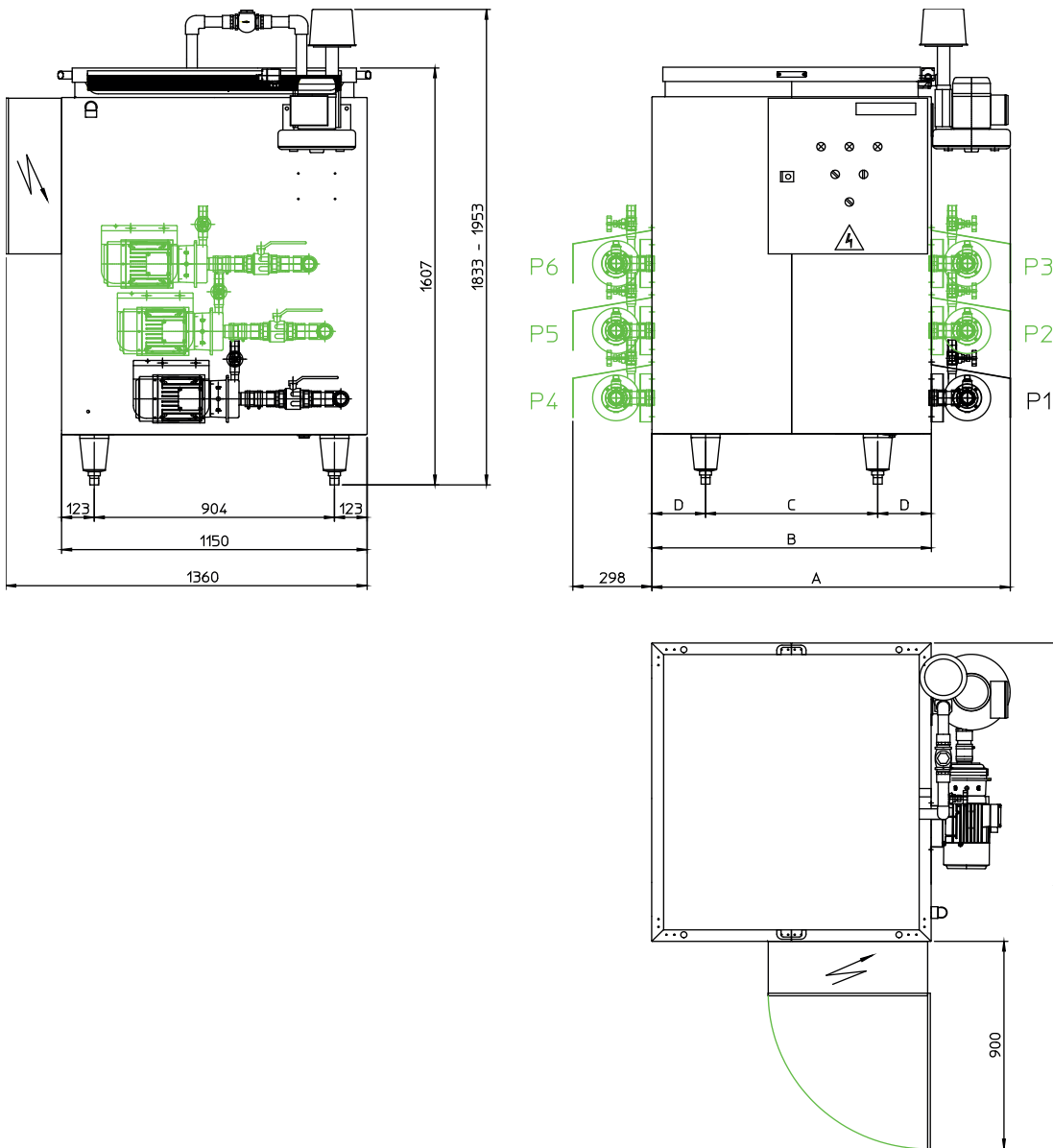

Model	Energy storage		Amount of ice kg	Amount of water (without ice) Litres	A mm	B mm	C mm	D mm	# Feet	Weight with 1 pump kg
	kWh	kcal								
25	25.8	22160	277	1154	1432	1052	648	202	4	320
40	41.2	35456	443	1154	1432	1052	648	202	4	370
60	61.8	53184	665	1692	1872	1492	1088	202	4	437
80	82.5	70912	886	2229	2312	1932	1528	202	4	532
120	123.7	106368	1330	3304	3192	2812	2408	202	6	690
160	164.9	141824	1773	4379	4072	3692	3288	202	6	840

### Fullwood Packo nv

Torhoutsesteenweg 154 - 8210 Zedelgem - Belgium  
T +32 50 25 06 10 - E [cooling@fullwoodpacko.com](mailto:cooling@fullwoodpacko.com)  
[www.packocooling.com](http://www.packocooling.com)

Subject to modifications. Not contractually binding document.